

**CATALINA-SUMMIT-SERIES-7 184BHS TRAVEL TRAILERS**

The 184BHS is the most versatile bunk house! This floor plan is towing friendly and suitable for most tow vehicles. Our double over double bunk beds offer more comfort and flexibility than traditional single bunks. The family friendly U-shape dinette slide out opens up this floor plan and provides storage underneath the benches as well as additional sleeping utility. Our fold down queen Murphy bed is the ultimate space saver! Enjoy the comfort and convenience of a sofa when the bed is stowed.

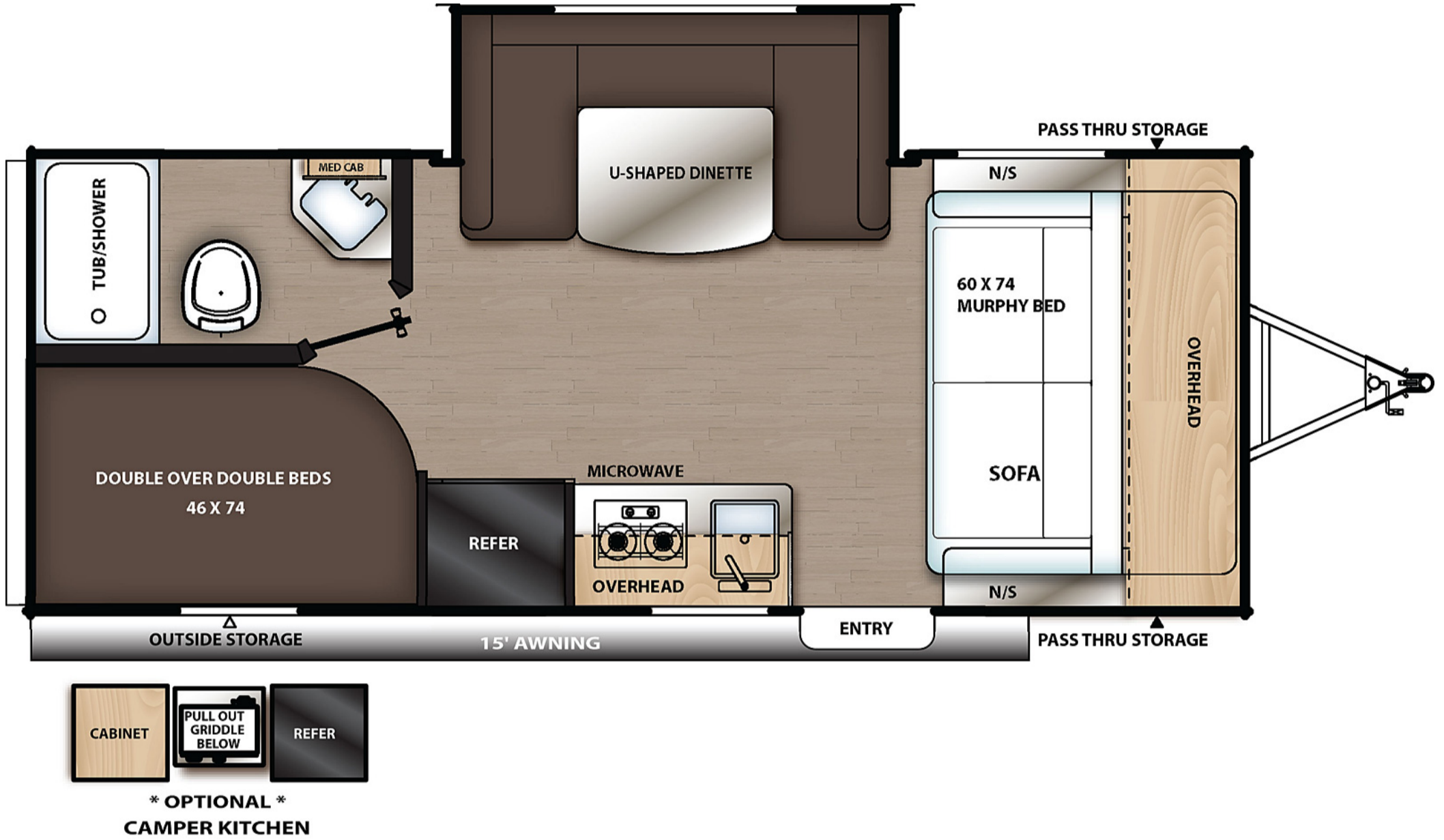

<b>Hitch Weight:</b>	492 lb.	<b>GVWR:</b>	5,500 lb.	<b>UVW</b>	4,202 lb.
<b>CCC</b>	1,298 lb.	<b>Exterior Length:</b>	23' 1"	<b>Exterior Height:</b>	10' 1"
<b>Exterior Width:</b>	90"	<b>Fresh Water:</b>	44.00 gal.	<b>Gray Water:</b>	30.00 gal.
<b>Black Water:</b>	30.00 gal.	<b>Awning Size:</b>	15'		

Note: Specifications are subject to change without notice.

**Specifications Definitions**

**GVWR (Gross Vehicle Weight Rating)** – is the maximum permissible weight of the unit when fully loaded. It includes all weights, inclusive of all fluids, cargo, optional equipment and accessories. For safety and product performance do NOT exceed the GVWR.

**GAWR (Gross Axle Weight Rating)** – is the maximum permissible weight, including cargo, fluids, optional equipment and accessories that can be safely supported by a combination of all axles.

**UVW (Unloaded Vehicle Weight)\*** – is the typical weight of the unit as manufactured at the factory. It includes all weight at the unit's axle(s) and tongue or pin and LP Gas. The UVW does not include cargo, fresh potable water, additional optional equipment or dealer installed accessories.

\*Estimated Average based on standard build optional equipment.

**CCC (Cargo Carrying Capacity) \*\*** – is the amount of weight available for fresh potable water, cargo, additional optional equipment and accessories. CCC is equal to GVWR minus UVW. Available CCC should accommodate fresh potable water (8.3 lbs per gallon). Before filling the fresh water tank, empty the black and gray tanks to provide for more cargo capacity.

\*\*Estimated Average based on standard build optional equipment.

Each Coachmen RV is weighed at the manufacturing facility prior to shipping. A label identifying the unloaded vehicle weight of the actual unit and the cargo carrying capacity is applied to every Coachmen RV prior to leaving our facilities.

The load capacity of your unit is designated by weight, not by volume, so you cannot necessarily use all available space when loading your unit.

Actual towing capacity is dependent upon your particular loading and towing circumstances, which includes the GVWR, GAWR and GCWR as well as adequate trailer brakes. Please refer to the Operator's Manual of your vehicle for further towing information.

Note: Specifications are subject to change without notice.